

Deep Groove Ball Bearings

- Series
- 62
 - 62 Z
 - 62 ZZ
 - 62 RS
 - 62 2RS
 - 62 N
 - 62 ZN
 - 62 ZZN

Bearing Type	Dimensions				Load Rating		Speed Limit	
	d (mm)	D (mm)	B (mm)	r _{min} (mm)	CISO (kN)	C0,ISO (kN)	Grease (rpm)	Oil
6200	10	30	9	0.6	5.97	2.63	24 000	30 000
6201	12	32	10	0.6	6.89	3.09	22 000	28 000
6202	15	35	11	0.6	7.73	3.76	19 000	24 000
6203	17	40	12	0.6	9.55	4.76	17 000	21 000
6204	20	47	14	1	12.79	6.58	14 000	17 000
6205	25	52	15	1	14.02	7.88	12 000	14 500
6206	30	62	16	1	19.45	11.26	10 000	12 500
6207	35	72	17	1.1	25.67	15.30	8 800	11 000
6208	40	80	18	1.1	29.11	17.90	7 800	9 500
6209	45	85	19	1.1	32.71	20.46	7 300	8 800
6210	50	90	20	1.1	35.07	23.18	6 600	8 300
6211	55	100	21	1.5	43.38	29.22	6 100	7 500
6212	60	110	22	1.5	52.42	36.17	5 400	6 700
6213	65	120	23	1.5	57.21	40.00	5 000	6 200
6214	70	125	24	1.5	62.19	43.99	4 700	5 800
6215	75	130	25	1.5	67.36	48.18	4 400	5 400
6216	80	140	26	2	72.67	53.00	4 200	5 200
6217	85	150	28	2	83.97	61.89	3 900	4 800
6218	90	160	30	2	95.98	71.45	3 700	4 500
6219	95	170	32	2.1	108.70	81.70	3 500	4 300

Bearing Type	Dimensions				Load Rating		Speed Limit	
	d (mm)	D (mm)	B (mm)	r _{min} (mm)	CISO (kN)	C0,ISO (kN)	Grease (rpm)	Oil
6220	100	180	34	2.1	122.11	92.88	3 300	4 000
6222	110	200	38	2.1	144.05	117.25	3 000	3 600
6224	120	215	40	2.1	155.30	131.13	2 600	3 200
6226	130	230	40	3	166.78	146.25	2 300	2 800

Self-aligning Ball Bearings

Series 12
12 K
23
23 K

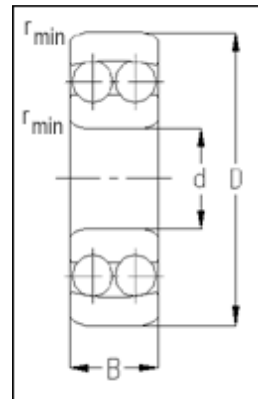

Bearing Type	Dimensions				Load Rating		Speed Limit	
	d (mm)	D (mm)	B (mm)	r _{min} (mm)	CISO (kN)	C0,ISO (kN)	Grease (rpm)	Oil
1205	25	52	15	1	12.11	3.31	12 500	16 000
1206	30	62	16	1	15.64	4.70	10 000	12 500
1207	35	72	17	1.1	15.78	5.14	9 000	11 000
1208	40	80	18	1.1	19.24	6.51	8 000	10 000
1209	45	85	19	1.1	21.80	7.36	7 500	9 000
1210	50	90	20	1.1	22.71	8.09	6 800	8 200
1211	55	100	21	1.5	26.79	10.04	6 200	7 400
1212	60	110	22	1.5	30.15	11.56	5 600	6 700
1213	65	120	23	1.5	30.99	12.37	5 200	6 200
1214	70	125	24	1.5	34.65	13.69	4 900	5 900
1215	75	130	25	1.5	38.84	15.54	4 700	5 600
1216	80	140	26	2	39.83	16.93	4 400	5 200
2305	25	62	24	1.1	24.45	6.53	10 000	12 000

Deep Groove Ball Bearings
Thin Series 160

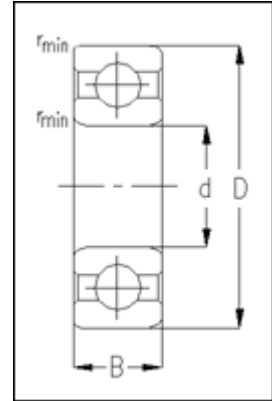

Bearing Type	Dimensions				Load Rating		Speed Limit	
	d (mm)	D (mm)	B (mm)	r _{min} (mm)	CISO (kN)	CO,ISO (kN)	Grease ng (rpm)	Oil
16002	15	32	8	0.3	5.59	2.84	22 000	28 000
16003	17	35	8	0.3	6.00	3.25	20 000	25 000
16004	20	42	8	0.3	7.91	4.48	16 500	21 000
16005	25	47	8	0.3	8.86	5.61	14 000	18 000
16006	30	55	9	0.3	11.22	7.39	12 000	15 000
16007	35	62	9	0.3	12.22	8.84	10 500	13 000
16008	40	68	9	0.3	12.62	9.65	9 500	12 000
16009	45	75	10	0.6	15.54	12.25	8 500	10 500
16010	50	80	10	0.6	15.99	13.23	8 000	10 000
16011	55	90	11	0.6	19.35	16.31	7 100	9 000
16012	60	95	11	0.6	19.86	17.57	6 700	8 000
16013	65	100	11	0.6	17.15	15.93	6 300	7 500
16014	70	110	13	0.6	26.79	23.55	5 700	6 800
16015	75	115	13	0.6	27.50	25.31	5 400	6 500
16016	80	125	14	0.6	31.73	29.72	5 000	6 000
16017	85	130	14	0.6	32.64	31.55	4 800	5 700
16018	90	140	16	1	39.85	36.96	4 500	5 400

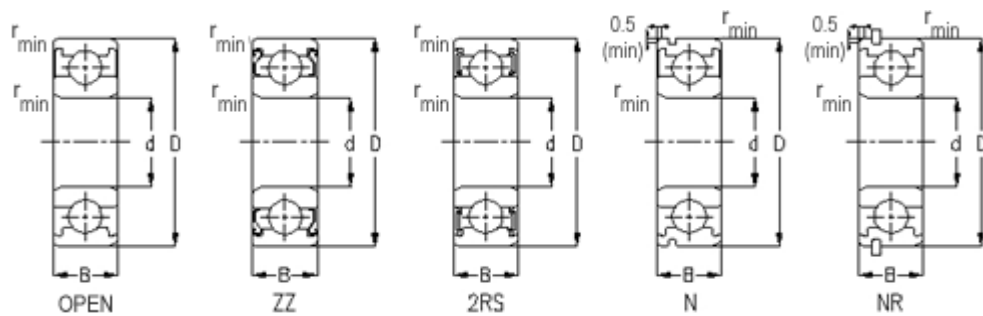

Deep Groove Ball Bearings
Series

60, 60 Z, 60 ZZ, 60 RS, 60 2RS, 60 N, 60 ZN, 60 ZZN

Bearing Type	Dimensions				Load Rating		Speed Limit	
	d	D	B	r _{min}	CISO	C0,ISO	Grease	Oil
	(mm)	(mm)	(mm)	(mm)	(kN)	(kN)	ng (rpm)	
6000	10	26	8	0.3	4.58	1.97	28 500	35 000
6001	12	28	8	0.3	5.10	2.37	25 500	32 000
6002	15	32	9	0.3	5.59	2.84	22 000	28 000
6003	17	35	10	0.3	6.00	3.25	20 000	25 000
6004	20	42	12	0.6	9.38	5.03	16 500	20 000
6005	25	47	12	0.6	10.07	5.83	14 500	18 000
6006	30	55	13	1.0	13.23	8.28	12 000	15 000
6007	35	62	14	1.0	15.98	10.28	10 500	13 000
6008	40	68	15	1.0	16.77	11.55	9 500	12 000
6009	45	75	16	1.0	20.98	15.15	8 500	10 500

6010	50	80	16	1.0	21.79	16.58	8 000	10 000
6011	55	90	18	1.1	28.27	21.25	7 200	9 000
6012	60	95	18	1.1	29.44	23.16	6 700	8 000
6013	65	100	18	1.1	30.54	25.15	6 300	7 500
6014	70	110	20	1.1	38.05	30.87	5 700	6 800
6015	75	115	20	1.1	39.52	33.47	5 400	6 500
6016	80	125	22	1.1	47.64	39.68	5 000	6 000
6017	85	130	22	1.1	49.53	42.98	4 800	5 800
6018	90	140	24	1.5	58.16	49.60	4 500	5 400
6019	95	145	24	1.5	60.36	53.87	4 300	5 200

Bearing Type	Dimensions				Load Rating		Speed Limit	
	d	D	B	r _{min}	CISO	C0,ISO	Grease	Oil
	(mm)	(mm)	(mm)	(mm)	(kN)	(kN)	ng (rpm)	
6020	100	150	24	1.5	60.14	54.18	4 100	4 900
6021	105	160	26	2.0	72.30	65.77	3 900	4 700
6022	110	170	28	2.0	81.97	72.75	3 700	4 400
6024	120	180	28	2.0	84.94	79.23	3 400	4 000
6026	130	200	33	2.0	106.35	100.61	3 100	3 700
6028	140	210	33	2.0	109.99	108.64	2 800	3 300

Deep Groove Ball Bearings
Wide Series 62200

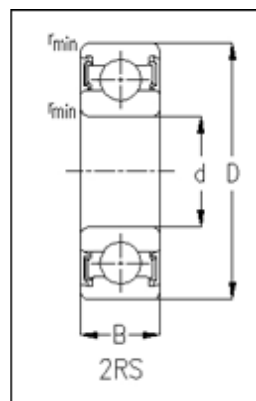

Bearing Type	Dimensions				Load Rating		Speed Limit	
	d	D	B	r _{min}	CISO	C0,ISO	Grease	Oil
	(mm)	(mm)	(mm)	(mm)	(kN)	(kN)	ng (rpm)	
62200	10	30	14	0.6	5.97	2.63	24 000	30 000

62201	12	32	14	0.6	6.89	3.09	22 000	28 000
62202	15	35	14	0.6	7.73	3.76	19 000	24 000
62203	17	40	16	0.6	9.55	4.76	17 000	21 000
62204	20	47	18	1	12.79	6.58	14 000	17 000
62205	25	52	18	1	14.02	7.88	12 000	14 500
62206	30	62	20	1	19.45	11.26	10 000	12 500
62207	35	72	23	1.1	25.67	15.30	8 800	11 000
62208	40	80	23	1.1	29.11	17.90	7 800	9 500
62209	45	85	23	1.1	32.71	20.46	7 300	8 800
62210	50	90	23	1.1	35.07	23.18	6 600	8 300

Deep Groove Ball Bearings
Wide Series 62300

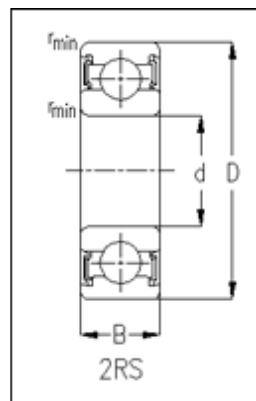

Bearing Type	Dimensions				Load Rating		Speed Limit	
	d (mm)	D (mm)	B (mm)	r _{min} (mm)	C ₁₀ ,ISO (kN)	C ₀ ,ISO (kN)	Grease ng (rpm)	Oil
62300	10	35	17	0.6	8.10	3.44	20 000	25 000
62301	12	37	17	1	9.71	4.19	18 500	23 000
62302	15	42	17	1	11.33	5.35	15 500	20 000
62303	17	47	19	1	13.63	6.62	14 000	17 000
62304	20	52	21	1.1	15.94	7.88	12 000	15 000
62305	25	62	24	1.1	23.62	12.13	10 000	12 000

62306	30	72	27	1.1	28.16	15.82	8 400	10 000
62307	35	80	31	1.5	33.32	19.15	7 300	9 000
62308	40	90	33	1.5	40.72	23.94	6 700	8 000

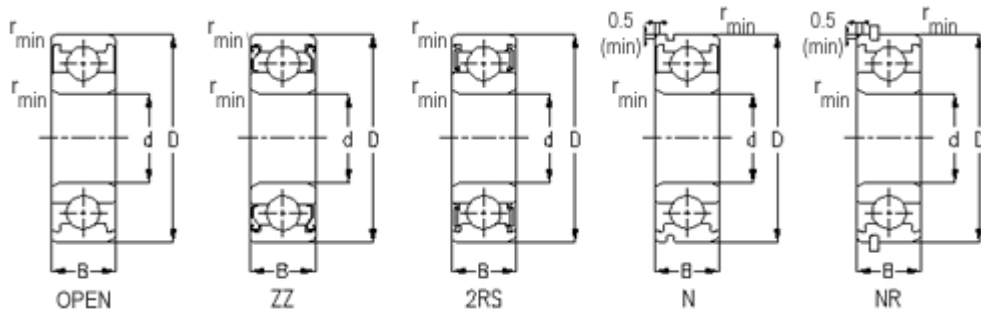

Deep Groove Ball Bearings
Series

- 6300
- 6300 Z
- 6300 ZZ
- 6300 RS
- 6300 2RS
- 6300 N
- 6300 ZN
- 6300 ZZN

Bearing Type	Dimensions				Load Rating		Speed Limit	
	d (mm)	D (mm)	B (mm)	r _{min} (mm)	CISO (kN)	C0,ISO (kN)	Grease ng (rpm)	Oil
6300	10	35	11	0,6	8,10	3,44	20 000	25 000
6301	12	37	12	1	9,71	4,19	18 500	23 000
6302	15	42	13	1	11,33	5,35	15 500	20 000
6303	17	47	14	1	13,63	6,62	14 000	17 000

6304	20	52	15	1,1	15,94	7,88	12 000	15 000
6305	25	62	17	1,1	23,62	12,13	10 000	12 000
6306	30	72	19	1.1	28,16	15,82	8 400	10 000
6307	35	80	21	1.5	33,32	19,15	7 300	9 000
6308	40	90	23	1.5	40,72	23,94	6 700	8 000
6309	45	100	25	1.5	52,77	31,67	5 900	7 100
6310	50	110	27	2	62,00	38,19	5 300	6 500
6311	55	120	29	2	71,48	44,58	4 800	6 000

6312	60	130	31	2.1	81,85	52,04	4 500	5 500
6313	65	140	33	2.1	92,64	59,67	4 200	5 000
6314	70	150	35	2.1	104,13	68,04	3 800	4 500
6315	75	160	37	2.1	113,42	76,96	3 600	4 200
6316	80	170	39	2.1	122,94	86,50	3 400	4 000
6317	85	180	41	3	132,67	96,58	3 200	3 800
6318	90	190	43	3	142,61	107,23	3 000	3 600
6319	95	200	45	3	152,74	118,42	2 800	3 400
6320	100	215	47	3	173,17	140,89	2 600	3 200
6322	110	240	50	3	205,36	179,35	2 300	2 800

Deep Groove Ball Bearings
Wide Series 63000

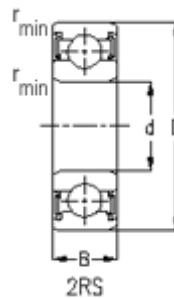

Bearing Type	Dimensions				Load Rating		Speed Limit	
	d (mm)	D (mm)	B (mm)	rmin (mm)	CISO (kN)	C0,ISO (kN)	Grease ng (rpm)	Oil
63000	10	26	12	0.3	4.58	1.97	28 500	35 000
63001	12	28	12	0.3	5.10	2.37	25 500	32 000
63002	15	32	13	0.3	5.59	2.84	22 000	28 000
63003	17	35	14	0.3	6.00	3.25	20 000	25 000
63004	20	42	16	0.6	9.38	5.03	16 500	20 000
63005	25	47	16	0.6	10.07	5.83	14 500	18 000
63006	30	55	19	1.0	13.23	8.28	12 000	15 000

63007	35	62	20	1.0	15.98	10.28	10 500	13 000
63008	40	68	21	1.0	16.77	11.55	9 500	12 000

Deep Groove Ball Bearings
Series 64
64 N

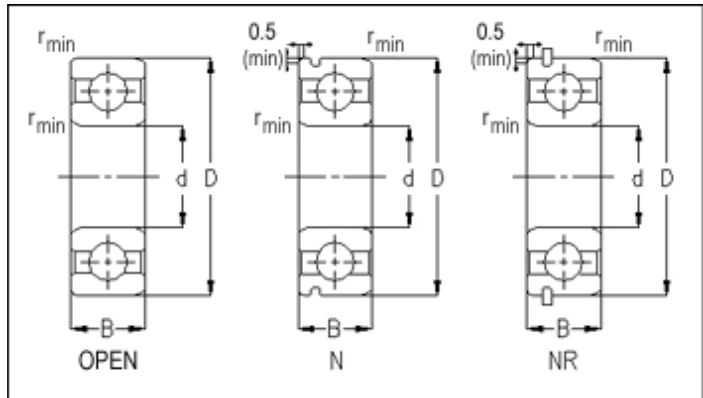

Bearing Type	Dimensions				Load Rating		Speed Limit	
	d (mm)	D (mm)	B (mm)	r _{min} (mm)	CISO (kN)	C0,ISO (kN)	Grease ng (rpm)	Oil
6405	25	80	21	1.5	36.12	19.45	8 500	10 000
6408	40	110	27	2	63.71	36.58	6 000	7 100
6409	45	120	29	2	77.21	45.20	5 600	6 700
6410	50	130	31	2.1	83.05	49.37	5 000	6 000